

PCB dimension
(typical)

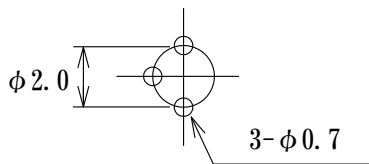

Acceptable Plug $\phi 0.45$ typical

Date		JC ELECTRONICS CORPORATION	
2016/07/21			
Materials Finish		SOCKET PINS	Contact: Beryllium Copper Gold over Ni Plated
		INSULATOR	Body: Brass Gold over Ni Plated PPS (Black)
Dimensions Style		Title	
mm		LASER DIODE SOCKET	
	Third Angle Projection	Part Number	
Rev. No	0	LD200P-3P-F8-E	

Ⓐ